

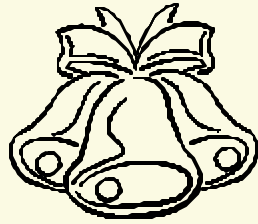

# *2007 Wedding Planner*

*T*he White House of Wilmington  
178 Route 9 East  
Wilmington VT 05363  
800 541 2135



## *Basic Rates 2007 Weddings*

A \$900.00 deposit is required in order to confirm your reservation for the facility. A check or cash payment is accepted and is not refundable.

The facility fee is dependant upon the season and the number of guests attending the wedding. The fee may range from \$900 to \$2,000. In some instances we have waived the facility fee for off season weddings.

Please find the enclosed rate sheet for our guest rooms. All room rates are based on double occupancy, each additional person is \$15.00 per night.

A five hour open bar averages approximately \$38.00 per person. Your cost is based on actual consumption.

Champagne Toast with our house champagne is offered for \$3.50 per person.

Coffee & Punch are offered throughout the reception at a cost of \$2.50 per guest.

Hors d' Oeuvres vary by selection and average \$8.00 to \$12.00 per guest.

Entrees range from \$27 to \$33 per person and include salad.

All rooms, food, and liquor are subject to applicable state taxes and 20% gratuity.

Cakes, Flowers, Music, and Photographer are not included. We gladly provide you with a list of local professionals that have previously offered their services at the White House.

Chair Rentals for services are available for \$2.50 to include setup & take down.

Rehearsal Dinner barbecue is offered in our formal flower garden for \$23.95.

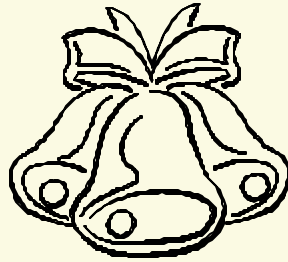

## *Sumptuous Samplings*

### Hors d' Oeuvres

Stuffed Mushrooms  
Baked Brie  
Crostinis  
Smoked Canadian Lake Trout  
Scallops Wrapped in Bacon  
Shrimp Cocktail  
Escargot & Brochette  
Calamari & Brochette  
International Cheese Board  
Fruit Tray

### Entrees

Salmon  
Shrimp  
Prime Rib  
Filet Mignon  
Lamb Loin  
Pork Loin  
Boneless Chicken Breast  
Boneless Stuffed Duck *our specialty*  
Vegetarian Dish

These items are not your only choices; rather they are included in order to give you an understanding of what we have done in the past. We are happy to consider your food requests during our consultations.

## *Why We Believe We Are...*

### The Premier Wedding Facility in Southern Vermont

In the 29 years that Innkeeper, Robert Grinold has been helping to orchestrate weddings, he has learned that no two weddings are the same.

Your wedding is exactly that, ..... *your* wedding. We will assist you in making your perfect dream day a reality. We understand that you have very particular ideas about how some aspects of your wedding will be planned. Yet, we have learned that you probably have not even considered some important details. Our experience in assisting with the planning of weddings will assure you of a day that everyone will recall with fondness.

Without exception, The White House is the most scenic setting in southern Vermont for your wedding. Our formal flower gardens surround a bubbling fountain, sitting at the foot of an eight-collumned-rose arbor. The brick path winds its way past the gardens and fountains until reaching the rose-filled trellace.

When you take into consideration the stately impression of the Inn and its' architecture; surrounded by 25 acres of well-manicured lawns, flower gardens, fountains, and mountain views, it is readily obvious why the Boston Herald named, "The White House as one of the ten most romantic places in the world".

We believe that the combination of our experience, scenic beauty, and romantic surroundings makes us,

.....Vermont's Premier Wedding Facility.

## Function Scheduling

A \$900.00 deposit is required in order to reserve the facility. This deposit is not refundable. **Payment by check is required.**

## Menu Selection

A preliminary menu selection should be discussed prior to reserving the facility. Final meal selection must be made prior to sending your invitations. Total number of guests to be invited must be confirmed with Inn. If more than one entree is selected you are responsible for an exact meal count for each entree. The enclosed list of entree's and hors d'oeuvres are for suggestion only. In most cases we are able to accommodate your specific selections.

## Seating Place Cards

A final meal count is required 2 weeks prior to your wedding. Each guest must have their own place card if you are offering a choice of meals. You need to place their meal selection code on the back of these cards. We will work with you on table arrangements as soon as we receive your final meal count. Depending on the number of guests attending your wedding, there may be some flexibility in table assignment.

## Function Hours & Facility Fee

The facility fee is \$900 unless otherwise noted. All functions are priced on a 5 hour facility fee with at least 75 guests in attendance. For a sit down dinner the Inn can accommodate up to 108. Use of the patio and bar area can bring this number to 125. Other arrangements can be made to accommodate up to 200. Any additional time incurs a \$200.00 per hour charge. Additional service requests may cause the facility fee to go as high as \$2000. Use of the Inn and its services prior to reception is not included with the facility fee. Such use will be billed hourly. Termination of beverage service to any guest is at the sole discretion of the bartender. A \$500 damage deposit is required two weeks prior to your wedding. Any unused portion, in whole or in part, will be applied to your balance.

## Tax & Gratuity

9% Vermont State Rooms & Meals Tax is added to all appropriate charges.  
10% Vermont State Tax is added to all alcohol charges. A 20% Gratuity is added to the **final** bill. Additional gratuities for exceptional service are at your discretion.

## Room Rental

You are responsible for renting all 25 rooms for two nights. Room rates are based on double occupancy. No reservations will be accepted until you submit your rooming form. Regretfully we are unable to offer any discounted room rates.

## Alcohol

You may have alcoholic beverages purchased off premise in your Guest Rooms. Otherwise, all beverages consumed on the property must be purchased through the Inn. This is a Vermont state law that is enforced and not flexible. Thank you for your understanding. The Inn's bar closes at midnight. All service ends at midnight.

## Other Professional Services

Those services not offered by the Inn, such as floral arrangements, cake baker, photographer, and entertainment must be arranged by the wedding couple. We have provided a list of professional services available in our area. We welcome those not on our list to provide services at the inn. However, please understand that it is not the responsibility of the Inn to provide support for these professionals. We are extremely limited on our cold storage and generally unable to provide any space for cakes or flowers.

## Check In

Check in is 2:00. We regret that we are unable to welcome your guests prior to check in. We are happy to greet the bride and groom at the hour of their convenience.

## Alcohol and Wine

On occasion we are asked to serve a "favorite, or special" wine. Vermont State law requires us to purchase all wine from a Vermont distributor. On request we will provide you with a list of all wines available through our distributors. Wine is sold throughout the country based on allocation. Wine that is sold in New Jersey may not even be available in Vermont. Your understanding in this matter is appreciated.

## Termination of Agreement

Upon receipt of your deposit all 25 guest rooms are confirmed. Unless otherwise noted, you are responsible for payment for two nights stay for all 25 rooms. You are also responsible for full payment for the total reception costs. In the unlikely event of the cancellation of your use of the facility, a termination fee will be based upon the average cost for a 75 person wedding to include open bar. Submission of your deposit serves to confirm your agreement to these terms.

# Professional Services

## Music & Entertainment

Dorset Trio	(802) 440-4512
Denning Disc Jockey Services	(800) 625-3622
Harp & Flute Performance	(518) 692-9740
Ralph Thomas-harpist	(802) 375-6612
Laraine & Skip Morrow	(802) 464-5523

## Photographers

Turnbull Photographers	(413) 337-4033
Bob Story	(802) 464-5977
Amy Love	(888) 731-3686
Irene Goyette	(802) 447-1272

## Wedding Cakes

Lisa Bigelow	(802) 258-2357
--------------	----------------

## Limousine Services

Classic Limousine	(800) 660 -1609
-------------------	-----------------

## Justice of the Peace

& Wedding license Info	(802) 464-5836
------------------------	----------------

## Florists

Fairview Gardens	(800) 792-1274
Boyd Family Farm	(802) 464-5618
Capefarm	(802) 464-7666

## Tents

Classical Tents	(800) 70-TENTS
-----------------	----------------

## *Cottage Rooms*

**Cottage Rooms:** Two luxury Suites, a common sitting room, and common kitchen.

**C1:** Ground Floor Room, Queen Bed, Fireplace (seasonal), sitting area, in-room whirlpool Tub, TV, DVD player.

Name: \_\_\_\_\_ \$220 per couple

**C2:** Second Floor Room, Queen Bed, Balcony (seasonal), sitting area, in-room whirlpool Tub, TV, DVD player.

Name: \_\_\_\_\_ \$265 per couple

9% Rooms and Meals Tax added to final bill

Additional occupancy requires \$30 additional charge per night.

Please note that these room rates only apply to spring and summer. All fall and winter rates are higher.

## *Guest House Rooms*

**Guest House:** 7 Rooms, one with two queen sized beds, one with fold out couch. All room rates are based on two people and include breakfast. Limited number of cots are available.

**GH #1      Two Queen Beds      \$130 per couple**

Name \_\_\_\_\_

**GH #2      Queen Bed      \$130 per couple**

Name \_\_\_\_\_

**GH #3      Queen Bed, Sofa Bed      \$130 per couple**

Name \_\_\_\_\_

**GH #4      Queen Bed      \$130 per couple**

Name \_\_\_\_\_

**GH #5      Queen Bed      \$130 per couple**

Name \_\_\_\_\_

**GH #6      Queen Bed (Hand-held shower)      \$130 per couple**

Name \_\_\_\_\_

**GH #7      Queen Bed      \$130 per couple**

Name \_\_\_\_\_

9% Rooms and Meals Tax added to final bill

Additional occupancy requires \$30 additional charge per night.

Please note that these room rates only apply to spring and summer. All fall and winter rates are higher.

# Inn Rooms

<b>Room #1 Queen Bed, fireplace, up to 1 cot</b>	\$162 per couple
Name _____	
<b>Suite Balcony, King Bed, sitting room, fireplace &amp; fold-out couch.</b>	\$264 per couple
Name _____	
<b>#4 Queen Bed, can connect to suite</b>	\$162 per couple
Name _____	
<b>#5 King Bed can connect to room #6</b>	\$162 per couple
Name _____	
<b>#6 Balcony, two queens, can connect to room #5</b>	\$184 per couple
Name _____	
<b>#7 Two Queens, up to 1 cot</b>	\$162 per couple
Name _____	
<b>#8 Queen Bed, can connect to room #9</b>	\$162 per couple
Name _____	
<b>#9 Queen Bed, fireplace, up to 1 cot, can connect #8</b>	\$162 per couple
Name _____	
<b>#10 Queen Bed</b>	\$162 per couple
Name _____	
<b>#11 Queen Bed, fold-out couch</b>	\$162 per couple
Name _____	
<b>#12 Sitting area with queen fold-out couch, fireplace, stairway to loft with queen bed</b>	\$162 per couple
Name _____	
<b>#14 Sitting area with queen fold-out couch, fireplace, stairway to loft with queen bed</b>	\$162 per couple
Name _____	
<b>#15 Balcony, Queen Bed, fireplace, whirlpool bath</b>	\$184 per couple
Name _____	
<b>#16 Balcony, Queen Bed, fireplace, whirlpool bath</b>	\$184 per couple
Name _____	
<b>#111 Balcony, Queen Bed, fireplace, whirlpool bath</b>	\$184 per couple
Name _____	
<b>#112 Balcony, Queen Bed, fireplace, whirlpool bath</b>	\$184 per couple
Name _____	

Additional occupancy requires \$30 additional charge per night.

9% Rooms and Meals Tax added to final bill. Please note that these room rates only apply to spring and summer. All fall and winter rates are higher.

## Churches

East Dover Baptist	348 6366
Jacksonville Community Church	368 7626
Newfane Congregational Church	365 4626
Our Lady of Fatima	464 7329
Wilmington Congregational Church	464-2736

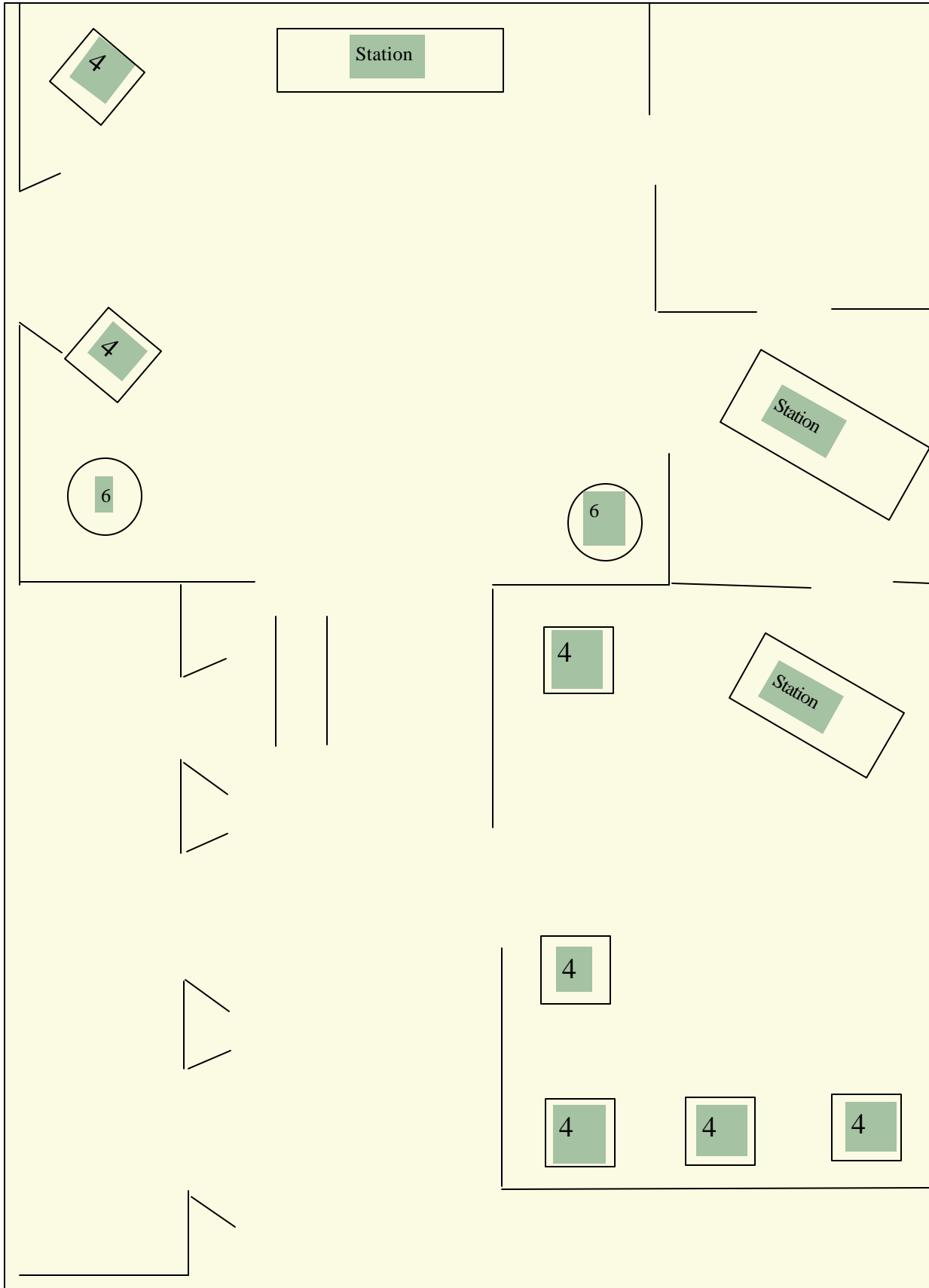

*Tent May have up to two stations, bar & Cake table*

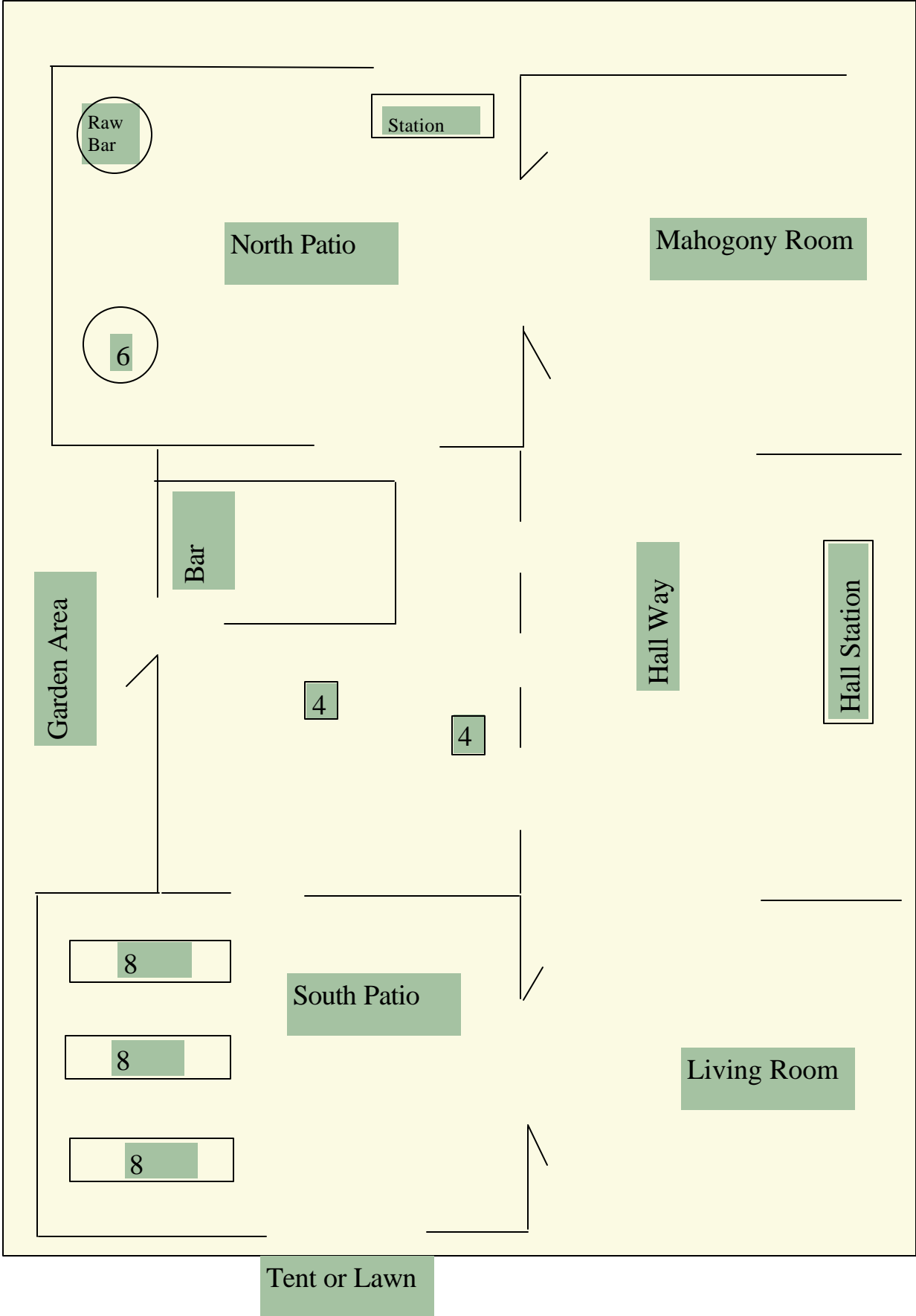

Tables By Room

## Mahogany Room

1	6' or 8' Station		
2	Rounds @ 6 each		12
2	Square @ 4 each		8

## Jefferson Room

1	12' Banquette		12-14
	or		
1	Round	@ 6 each	6
2	Square	@ 3 each	6

## Gold Room

1	6' Station		
5	Square @ 4 each		20

## North Patio

1	Raw Bar		
1	8' Station		
1	Round @ 6 each		6

## Bar Area

14		@ Bar itself	
2	Square @ 4 each		8

## South Patio

3	8' Banquette @ 8 each		24
---	-----------------------	--	----

## Tent

1	Cake Table		
1	Bar		
1	8' Station		
8	Rounds @ 8 each		64

**Total Seats** 166

## Sample Grazing I

### *Friday June*

- 2:00 Check In
- 5:00? Rehearsal

6:00? Barbecue in Gardens *approximately 50 Guests* \$22.95  
*Hamburger, hotdogs, sausage, pork loin, chicken, portabella mushrooms, corn, potato & pasta salad, grilled vegetables, lemonade.*  
*Coffee & Dessert to be included and served inside.*

*Cash Bar Available inside*

11:00 Close Bar

### *Saturday June*

- 8:00 to 9:30 Breakfast for all registered guests
- 3:00 Ceremony (10-15 Chairs on each side)
- 3:00 to 8:30 Facility Rental \$1000
- Additional Hour \$200
- 3:30 Photographs
- 3:30 Coffee & Punch \$2.00
- 3:30 Cash Bar and Hors D' Oeuvres

#### **Hors D'oeuvres**

Stuffed Mushrooms	\$1.75
Puffed Pastries (spinach and Garlic)	\$2.50
Shrimp Cocktail	\$3.50
Bruschetta with Mozarella	\$2.00
Cheese Table (to remain out during grazing)	\$5.00
Fruit Tray (with Cheese Table)	\$Comp

5:00 Begin Grazing

### **Grazing Stations \$35 per person**

It is important to understand that we will have a fixed amount of food available at each station. This will work out to the equivalent of 1-½ entrees per person. Inherent in this type of service is the fact that we will run out of one station prior to others. All of these stations will be manned during the dinner hour. (Around 1 1/2 hours)

## Carving Table

Prime Rib

Chilean Sea Bass (Lemon, Wine, Butter, and Garlic) *{market price}*

Chicken Saltimbuca

Green Beans with garlic

Roasted Red potatoes

Eggplant Parmesian

## Pasta Table

Hand-tossed pasta.

Penne

Cheese Tortellini

Alfredo

Pesto

Marinara

Vodka Sauce

Broccoli, Cauliflower, diced tomato, Mushrooms, peas, grated cheeses, prociutto, and herbs.

## Salad Station

Bowl of Mixed Greens with Wild Flowers and Mesculin

Assorted Dressings, Oil and Vinegar, Chopped Vegetables, grated cheese, croutons, pepper mill.

Bread

7:30 Champagne Toast

\$2.50

7:35 Cake Cutting

8:30 Facility Rental Ends

*9:30 Additional Hour Expires Reception Ends*

*Only one additional hour may be reserved..*

*12:00 Bar to Close*

## Sample Grazing II

### Hors D'oeuvres

Puffed Pastry	\$2.50
Scallops & Bacon	\$2.50
Smoked Trout	\$comp
Assorted Bruschetta	\$2.00
Spring Rolls	\$2.00
Cheese Table (to remain out during grazing)	\$5.00
Coffee & Punch	\$2.50

### 8:30 Begin Grazing

### Grazing Stations \$37 per person

It is important to understand that we will have a fixed amount of food available at each station. This will work out to the equivalent of 1-½ entrees per person. Inherent in this type of service is the fact that we will run out of one station prior to others. All of these stations will be manned during the dinner hour. (Around 1 1/2 hours)

### Carving Table

Filet Mignon  
Bernaise Sauce  
Mushroom Sauce  
Horseradish Cream Sauce  
  
Roasted Red Potato

### Pasta Table

Hand-tossed pasta  
Penne  
Cheese Tortellini

Alfredo  
Pesto  
Marinara  
Vodka Sauce

Broccoli, Cauliflower, diced tomato, Mushrooms, grated cheeses, prociutto, and herbs.

## Cheese Table

The following to be added to the Cheese Table:

Assorted Breads  
Proscuitto  
Olives  
Roasted Peppers  
Cold Marinated Grilled Vegetables  
Marinated Asparagus

## Salmon & Chicken

Poached Salmon  
Chicken Marsala

- 10:15 *Cut Cake*
- 12:00 *Reception Ends*
- 1:00 *Bar Area Closed*

*Sunday July 21, 2002*

**8:00 to 10:00 Breakfast for all registered guests**

- 11:00 Check Out

Sorbet

**Grazing:**

Sample Grazing III

\$35.00

7:15 Grilled Vegetables

7:30 Pasta Station

Ziti  
Tortellini  
Pesto  
Marinara  
Alfredo

Proscuitto  
Diced tomatoes & assorted vegetables  
Herbs

Carving  
Filet  
Turkey

Roasted Red Pot  
Glazed Carrots

Salmon & Chicken Marsala Station

9:00 Cake Cutting

## Sample Sit-Down

### *Friday June*

- 2:00 Check In
- 5:00 Rehearsal

6:00 Barbecue in Gardens *approximately 50 Guests* \$23.95  
*Hamburger, hotdogs, sausage, pork loin, chicken, portabella mushrooms, corn, potato & pasta salad, grilled vegetables, lemonade.*  
*Coffee & Dessert to be included and served inside.*

*Cash Bar Available inside*

11:00 Close Bar

### *Saturday June*

- 8:00 to 9:30 Breakfast for all registered guests
- 3:00 Ceremony (10-15 Chairs on each side)
- 3:00 to 8:30 Facility Rental \$1000
- Additional Hour \$200
- 3:30 Photographs
- 3:30 Coffee & Punch \$2.50
- 3:30 Cash Bar and Hors D' Oeuvres

#### **Hors D'oeuvres**

Stuffed Mushrooms	\$1.75
Puffed Pastries (spinach and Garlic)	\$2.50
Shrimp Cocktail	\$3.50
Bruschetta with Mozarella	\$2.00
Cheese Table (to remain out during grazing)	\$5.00
Fruit Tray (with Cheese Table)	\$Comp

- 5:00 **Dinner**

Choice of Entrée average \$30

- 6:30 Dancing Begins
- 7:30 Champagne Toast \$3.50
- 7:35 Cake Cutting
- 8:30 Facility Rental Ends
- 9:30 Additional Hour Expires Reception Ends

*Only one additional hour may be reserved..*